

# EXECUTIVE CONFERENCE CENTER (ECC)

## MODERN. FLEXIBLE. FULLY SUPPORTED.

Strategic Analysis, Inc.'s Executive Conference Center (ECC) is a full-service conference venue offering over 5,400 square feet of sleek, modern meeting and pre-function space—ideal for groups ranging from 10 to 135 attendees. Conveniently located in Arlington's Ballston neighborhood, just three blocks from the Ballston Metro station and minutes from Reagan National Airport (DCA).

We offer a professional environment suitable for sensitive discussions and specialized meeting requirements.

### What We Offer

- **Customizable Meeting Space:** Flexible layouts for trainings, board meetings, and hybrid events.
- **Integrated Audio Visual Technology:** Built-in, state-of-the-art A/V systems that meet modern hybrid standards.
- **Complimentary Refreshments:** All-day beverage service plus morning and afternoon snack offerings.
- **Purpose-Built Amenities:** Designed to foster collaboration, education, and engagement in a professional setting.
- **Dedicated On-Site Staff:** Our experienced conference and A/V team provides seamless support from planning through execution.

## AVAILABILITY AND RATES

At the ECC, we strive to take the stress away from planning your event. Whether you are a first-time planner or a seasoned professional, we work with you to ensure success. We offer daily rental rates that include meeting and pre-function space, meeting room audio visual and wireless internet, all-day beverages with a one-hour morning and afternoon prepackaged snack breaks, and knowledgeable, friendly staff to provide facility and technology support. For more information on rates and availability please visit us on the web at [ecc.sainc.com](http://ecc.sainc.com), call us at 703-797-4500 or email us at [ecc@sainc.com](mailto:ecc@sainc.com).

## CATERING

It is our mission to provide the best possible culinary offerings. We are pleased to recommend local catering options. Root and Stem Catering as our preferred caterer. Root and Stem is the first caterer ever to receive REAL Verification by the U.S. Healthful Food Council for their efforts to provide healthy, local, sustainable foods for their clients. They are familiar with the ECC's requirements regarding events in our facility and are flexible with any meeting budget.

- Root and Stem Catering, 703-289-1281 or [www.rootandstemdc.com](http://www.rootandstemdc.com)

If you would prefer to use a different caterer, please contact us at 703-797-4500.

## AUDIO VISUAL

The meeting rooms possess an impressive integrated audio-visual system allowing a quick connection to the client's webinar platforms, the ECC offers total presentation control to the host or presenter.

The following audio visual is included in your daily room rental:

- Ceiling mounted 6200 Luman Laser Projectors, 16:10 format projector and screens
- HDMI connection (with USB-C converters) for seamless projection simultaneously in-room and online webinar.
- Integrated presentation laptop computer (Windows operating system)
- Voice reinforcement and stereo audio systems
- Microphones (podium, wireless lavalier and handheld)
- Built-in room speakers
- Wireless slide advancer with built-in laser pointer for presentations
- Flipchart package
- Digital Room Signage
- Wireless Internet (wired available upon request)

For pricing on additional audio visual services and equipment, please contact us at [ecc@sainc.com](mailto:ecc@sainc.com).

## ECC 3RD FLOOR (SUITE 300)

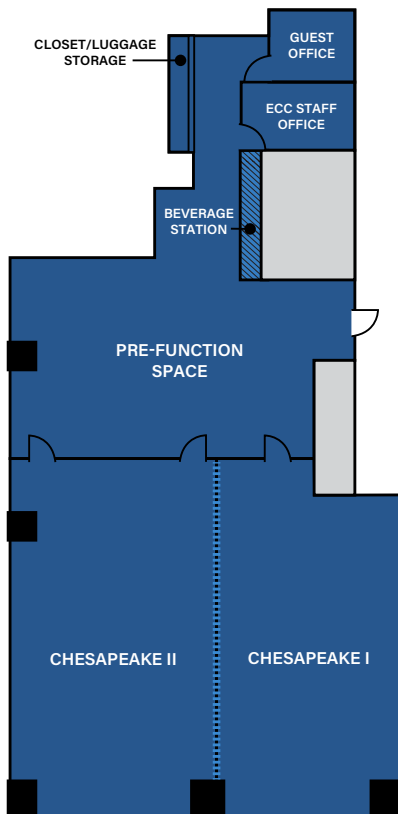

## KEY

- ECC 3rd Floor (Suite 300)
- SA HQ 2nd Floor (Suite 200)
- Elevators
- Restrooms
- Removable Wall
- Water Fountain

## SA HQ 2ND FLOOR (SUITE 200)

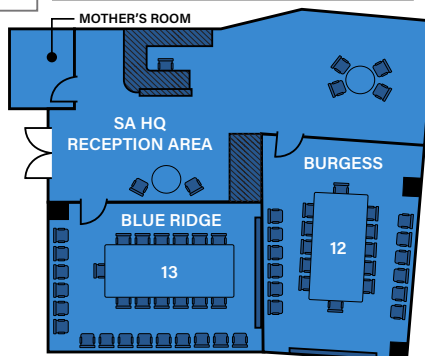
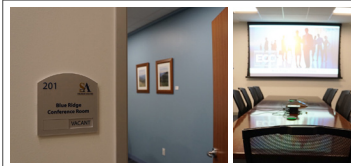

## Capacity Chart

Meeting Room	Dimensions (LxW)	Square Footage	Classroom	Theater	U-Shape Boardroom	Pods of 6 to 8
<b>ECC 3rd Floor (Suite 300)</b>						
Chesapeake I & II	~38' x 44'	1699	76	136	28 / 32	48 to 72
Chesapeake I	36' x 21'	756	36	60	20	18 to 24
Chesapeake II	41' x 23'	943	40	76	24	24
Guest Office	10' x 7' 5"	—	—	—	4	—
<b>SA HQ 2nd Floor (Suite 200) Conference Rooms</b>						
Blue Ridge	24' 8" x 17' 4"	423	—	15*	13	—
Burgess Executive	26' 7" x 16' 6"	442	—	12*	12	—

\* Maximum perimeter seating in addition to the existing boardroom table



## IN THE AREA



Scan for Area Information

## DINING

- Over 50 restaurants & eateries within 0.5 miles

## TRANSPORTATION

- Ronald Reagan National Airport (DCA), 7 miles
- Washington Dulles Airport (IAD), 22 miles
- Ballston-MU Metro Station, Orange and Silver Lines, 0.3 miles

## PARKING

- Parking is available directly under the building; located off N. Randolph Street and RIGHT of the half wall
- Additional parking garages available a few blocks away

## LODGING

- Residence Inn Arlington-Ballston
- Hilton Arlington
- The Westin Arlington Gateway
- Holiday Inn Arlington at Ballston



ECC Foyer (Suite 300)